

This drawing is the property of Equilibrium Architects and copyright is reserved by them. This drawing is not to be copied or disclosed by or to any unauthorised persons without the prior written consent of Equilibrium Architects.

Do not scale from this drawing.

All dimensions are to be checked on site prior to construction, manufacture of any components and ordering of materials and equipment.

Any discrepancies are to be reported to the architect for clarification.

All materials and workmanship to be in accordance with the current British Standards and codes of practice.

This drawing is to be read in conjunction with all relevant Architectural, Structural Engineers, Mechanical Engineers, Electrical Engineers and Specialists drawings and specifications.

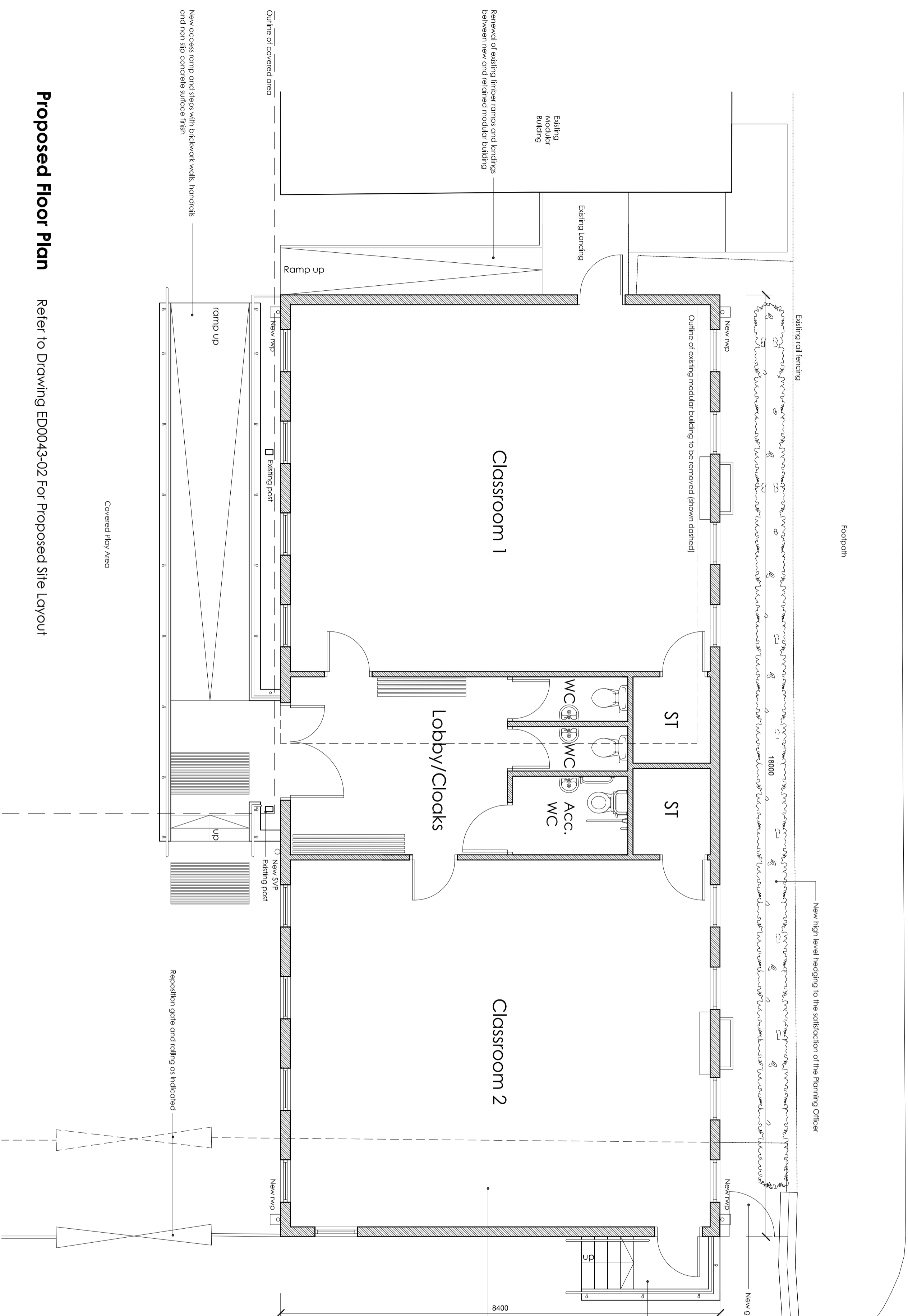

CLIENT  
St Andrews Primary School

PROJECT  
Provisional of a new modular building at St Andrews Primary School, Ramsbottom

DRAWING  
Proposed Floor Plan

REV	DESCRIPTION	CHECK	DATE
C	Window added, door and steps repositioned to side elevation		03.11.2017
B	Landskiped area added, gate added (North Side), Gate and railing repositioned		27.10.2017
A	Floor Plan updated		26.10.2017

SCALE	DATE	DRAWN	CHECKED
1:50 A2	Sept 2017	MH	
DRAWING NO.	CAD REFERENCE NO.	REVISION	
ED0043-03		C	

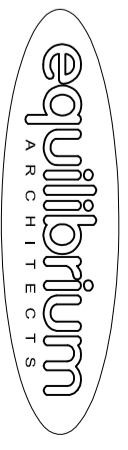

**Proposed Floor Plan** Refer to Drawing ED0043-02 For Proposed Site Layout